

NOTES:

1. PLANTING DETAILS SHALL BE PER CITY OF ARLINGTON REQUIREMENTS AND STANDARD DETAILS.
2. PRIOR TO PLANTING INCORPORATE A MINIMUM OF 4" DEPTH COMPOST INTO THE TOP 8" OF EXISTING SOIL IN ALL LANDSCAPE AREAS. ALTERNATIVELY A MINIMUM 8" DEPTH OF COMMERCIALY PREPARED TOPSOIL MAY BE USED IN PLANTING AREAS. SCARIFY SUBGRADE.
3. PROVIDE MINIMUM 2" DEPTH ARBORIST WOOD CHIP MULCH IN ALL PLANTING BEDS.
4. LANDSCAPE PLAN IS SCHEMATIC. ADJUST PLANTS IN THE FIELD AS NEEDED TO AVOID CONFLICTS.
5. ALL PLANT MATERIALS SHALL CONFORM TO THE LATEST ANLA STANDARDS.

PLANTING SCHEDULE:

TREES

QTY	BOTANICAL NAME	COMMON NAME	SIZE/CONDITION/REMARKS
28	CHAMAECYPARIS OBTUSA 'GRACILIS'	SLENDER HINOKI FALSE CYPRESS	2" CALIPER, TREE FORM, WELL-BRANCHED, FULL, B&B
40	CHAMAECYPARIS NOOTKATENSIS 'GREEN ARROW'	GREEN ARROW ALASKAN CEDAR	2" CALIPER, TREE FORM, WELL-BRANCHED, FULL, B&B
6	CORNUS 'EDDIE'S WHITE WONDER'	EDDIE'S WHITE WONDER DOGWOOD	2" CALIPER, TREE FORM, WELL-BRANCHED, FULL, B&B
2	FRAXINUS OXYCARPA 'RAYWOOD'	RAYWOOD ASH	2" CALIPER, TREE FORM, WELL-BRANCHED, FULL, B&B
2	THUJA PLICATA	WESTERN RED CEDAR	2" CALIPER, TREE FORM, WELL-BRANCHED, FULL, B&B

SHRUBS

QTY	BOTANICAL NAME	COMMON NAME	SIZE/CONDITION/REMARKS
35	CORNUS SANGUINEA 'MIDWINTER FIRE'	MIDWINTER FIRE DOGWOOD	#5 CONT, FULL
71	GAULTHERIA SHALLON	SALAL	#2 CONT, FULL
36	MAHONIA AQUIFOLIUM	TALL OREGON GRAPE	#2 CONT, FULL
18	PHILADELPHUS LEWISII	MOCK ORANGE	#5 CONT, FULL
54	RHODODENDRON 'KEN JANECK'	KEN JANECK RHODODENDRON	#2 CONT, FULL
26	RIBES SANGUINEUM 'KING EDWARD VII'	KING EDWARD VII FLOWERING CURRANT	#5 CONT, FULL
72	TAXUS X MEDIA 'HICKSI'	HICK'S YEW	#2 CONT, FULL

PERENNIALS, FERNS, GRASSES, AND GROUNDCOVERS

QTY	BOTANICAL NAME	COMMON NAME	SIZE/CONDITION/REMARKS
XX	ARCTOSAPHYLOS UVA-URSI	KINNIKINNICK	SP4, FULL, 24" O.C.
97	DESCHAMPSIA CESPITOSA	TUFTED HAIRGRASS	#1 CONT, FULL
XX	FRAGARIA CHILOENSIS	COASTAL STRAWBERRY	#1 CONT, FULL, 18" O.C.
XX	HAKONECHLOA MACRA 'AUREOLA'	JAPANESE FOREST GRASS	#1 CONT, FULL, 18" O.C.
24	HOSTA 'FRANCEE'	FRANCEE HOSTA	#1 CONT, FULL
XX	MAHONIA REPENS	CREEPING OREGON GRAPE	#1 CONT, FULL, 24" O.C.
87	POLYSTICHUM MUNITUM	WESTERN SWORD FERN	#2 CONT., MIN (10) FRONDS, 24" O.C.
			1,150 SF MULCH ONLY

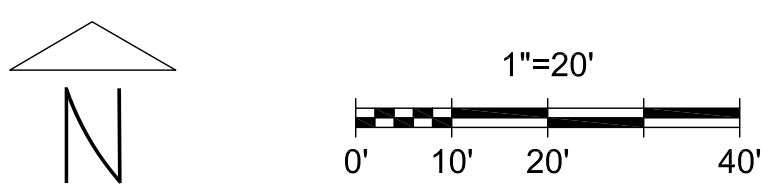
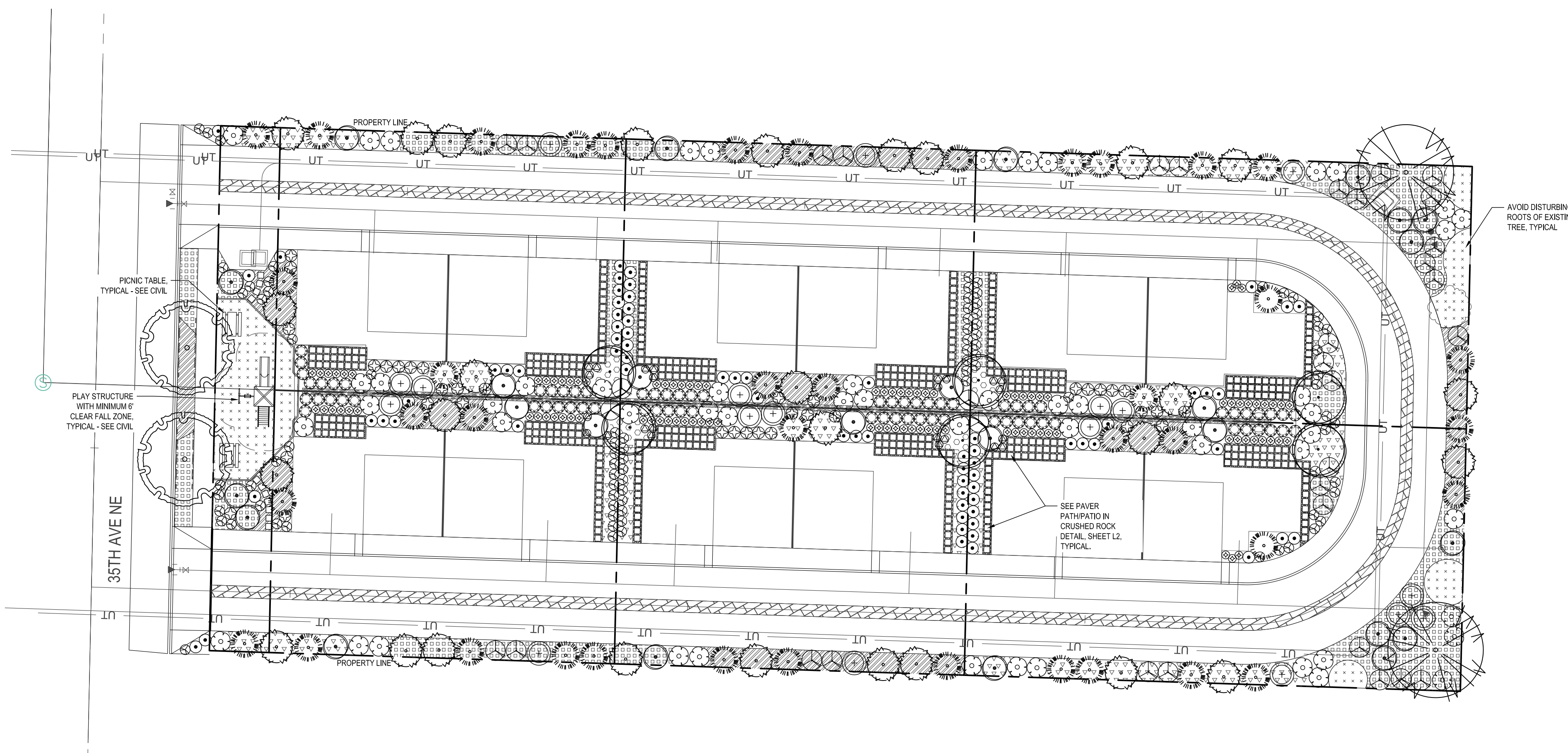

REVISIONS		
No.	REVISION	DATE
1		
2		

russell + lambert
LANDSCAPE ARCHITECTURE
7724 2nd Ave NE
Seattle, WA 98115

ENDORSEMENTS	
SIGNATURE	DATE
DRAWN: MER	4/19/2022
CHECK: RL	4/19/2022

LANDSCAPE PERMIT DRAWING
PLANTING PLAN

PROJECT TYPE: RESIDENTIAL DEVELOPMENT
PROJECT NAME: TOTEMWOOD TOWNHOMES
PROJECT ADDRESS: 18601 35TH AVE NE ARLINGTON, WA 98223

SHEET OF	
CLASS SHEET	L1
CITY	ARLINGTON
SCALE	AS SHOWN
REV. NO.	0

NOTES:

- 1) MULCH COMPLETELY BETWEEN ALL PLANTS.
- 2) STAKE TREES 5' IN HEIGHT OR GREATER ONLY.
- 3) PLANT SO THAT TOP OF ROOT BALL IS EVEN WITH FINISHED GRADE.
- 4) COMPLETELY REMOVE ALL WIRE AND LOOSEN FABRIC ON BALLED & BURLAPPED PLANTS.
- 5) SCARIFY SIDES OF PLANTING PITS PRIOR TO BACKFILLING.
- 6) PROVIDE (1) SLOW RELEASE WATERING BAG PER TREE.

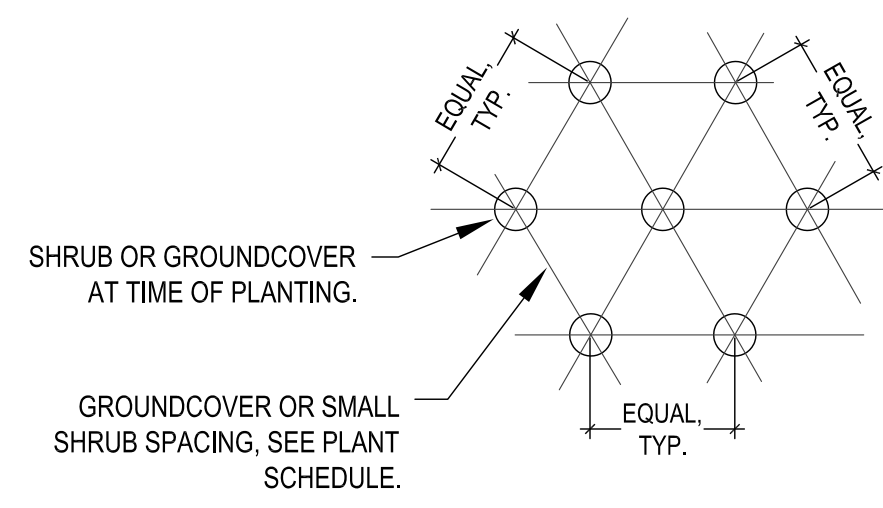

A TYPICAL PLANT SPACING
NOT TO SCALE

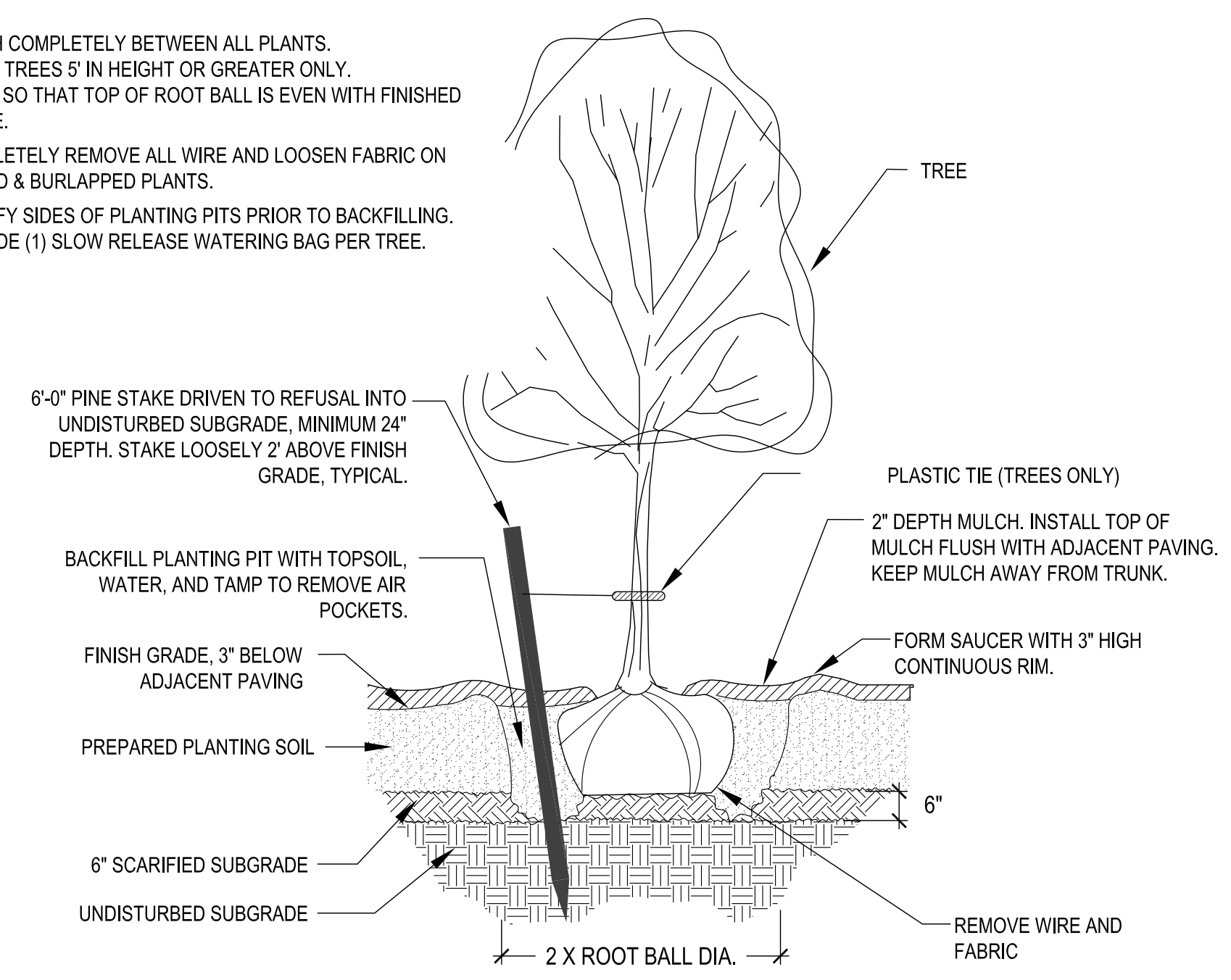

B TREE PLANTING DETAIL
NOT TO SCALE

NOTES:

- 1) MULCH COMPLETELY BETWEEN ALL PLANTS.
- 2) PLANT SO THAT TOP OF ROOT BALL IS EVEN WITH FINISHED GRADE.
- 3) COMPLETELY REMOVE ALL WIRE AND LOOSEN FABRIC ON BALLED & BURLAPPED PLANTS.
- 4) SCARIFY SIDES OF PLANTING PITS PRIOR TO BACKFILLING.

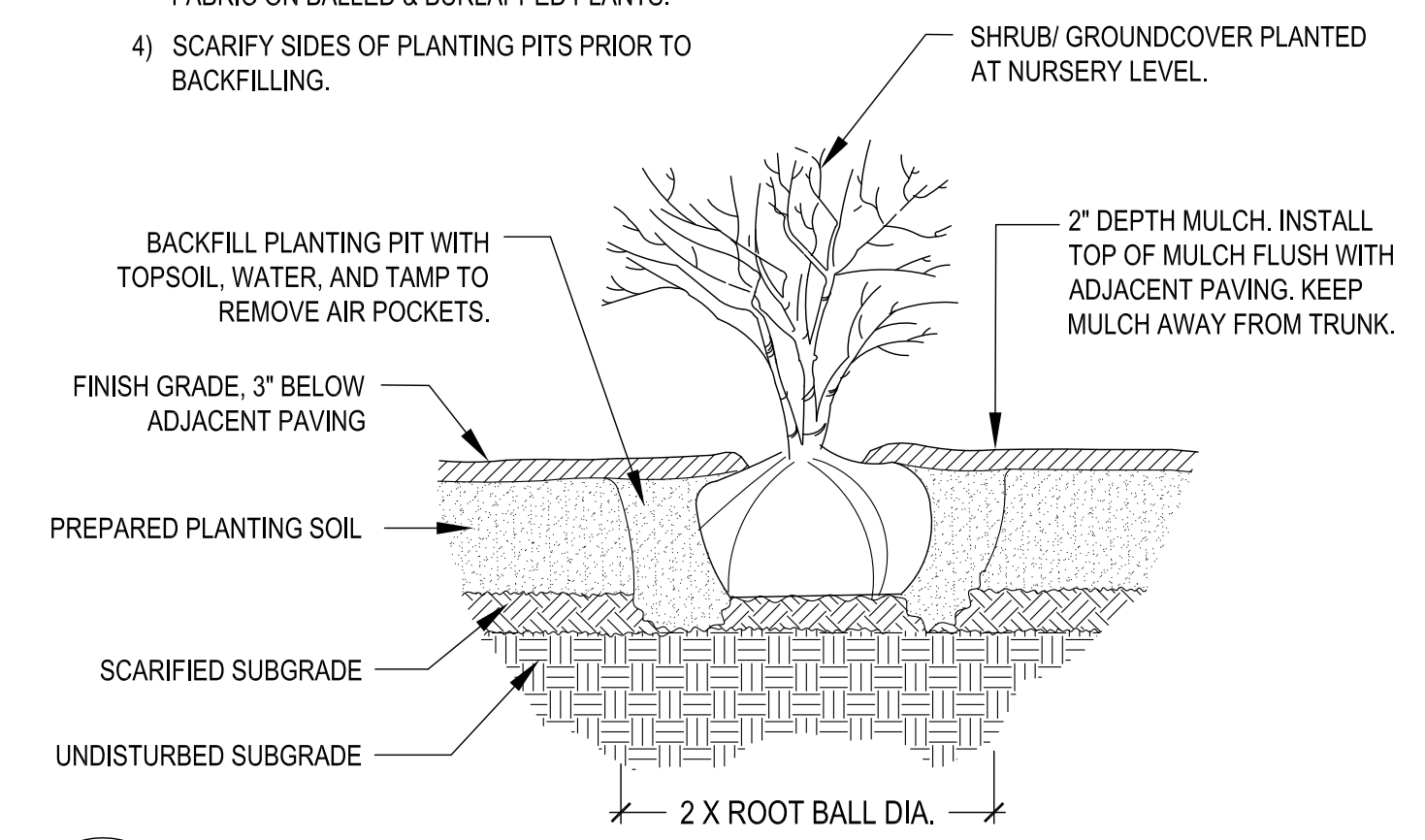

C SHRUB & GROUNDCOVER PLANTING DETAIL
NOT TO SCALE

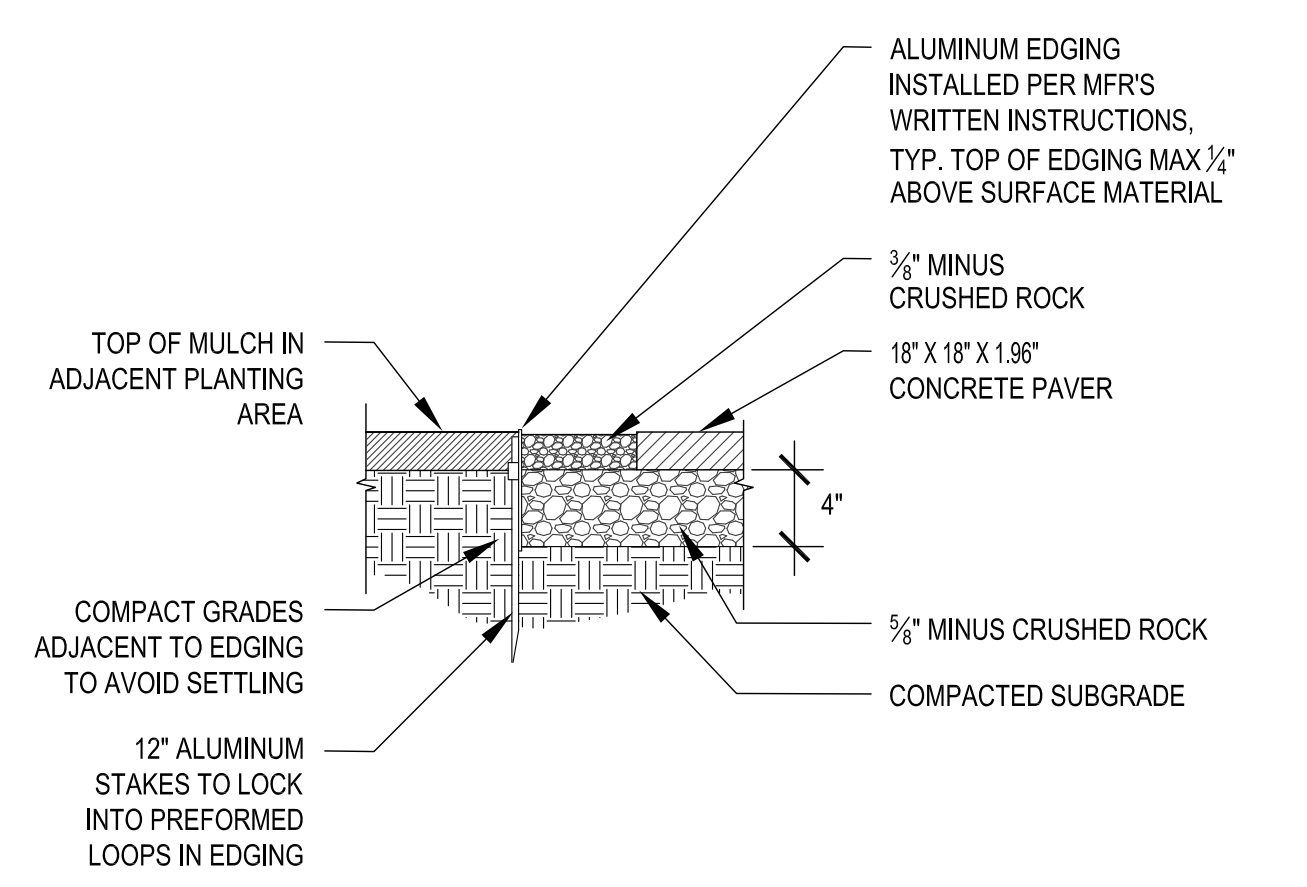

D PAVER PATH/ PATIO IN CRUSHED ROCK DETAIL
NOT TO SCALE

ONE INCH
AT FULL SIZE

REVISIONS		
No.	REVISION	DATE
1		
2		

russell + lambert
LANDSCAPE ARCHITECTURE
7724 2nd Ave NE
Seattle, WA 98115

RUSSELL + LAMBERT
LANDSCAPE ARCHITECTURE

ENDORSEMENTS	
SIGNATURE	DATE
DRAWN: MER	4/19/2022
CHECK: RL	4/19/2022

LANDSCAPE PERMIT
DRAWING

PLANTING DETAILS

PROJECT TYPE: RESIDENTIAL DEVELOPMENT
PROJECT NAME: TOTEMWOOD TOWNHOMES
PROJECT ADDRESS: 18601 35TH AVE NE ARLINGTON, WA 98223

SHEET	OF
CLASS / SHEET	L2
CITY	ARLINGTON
SCALE	REV. NO.
AS SHOWN	0